

## LASER POINTER LSVR12 SERIES - GREEN LIGHT - Ø12 - 3mW

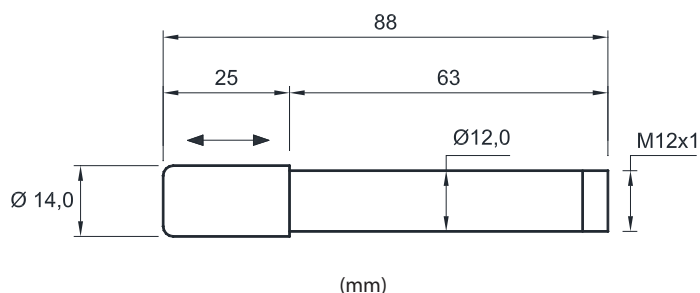

Laser pointer made of a high quality green laser diode, available with 520 nm wavelength and a power of 3 mW.

The ring allows an easy focus adjustment.











Connection M12x1 connector



1 = Brown = Positive + Vcc.  
2 = Free  
3 = Blue = Negative GND  
4 = Free

Accessories page 52

Type	LSVR12-520-3-T10-P-Y1	LSVR12-520-3-T10-X-Y1	LSVR12-520-3-T10-60-Y1	LSVR12-520-3-T10-75-Y1
Art. no.	SM318011	SM318012	SM318013	SM318014
Mounted lens	point	cross Plastics Diffractive Lens	line with lens 60° Glass Rod Lens	line with lens 75° Glass Rod Lens
Point diameter at 1 m distance ~	Ø 2,5 mm	-	-	-
Cross dimension at 1 m distance	-	120x120 mm	-	-
Line length at 1 m distance	-	-	1.100 mm	2.000 mm
Power supply	5...24 Vdc			
Power	3 mW			
Wavelength	520 nm			
Beam divergence	0,4 mrad	-	-	-
Life time at 20°C	≥ 10.000 h (with metal bracket)			
Permitted temperature	-10°...+50°C			
Focus adjustment	si			
Tolerance of the lens for line	± 15%			
Minimum line thickness	-	~ 1,5 mm	~ 2 mm	~ 1,5 mm
Current consumption	~ 30 mA typical			
Automatic control of the output power	yes			
Reverse polarity and overvoltage protections	yes			
Housing material	aluminum			
Connection	connector M12x1			
Degree of protection	IP67 frontal / IP54 body			
Safety protection class	<div><div></div><div></div><div></div></div>			
For the classification of the laser systems: only in perfect conditions and supplied with DC power supply, the system can be specified in the safety class, according to the new regulations in force since 12/15.				
READ THE INSTRUCTIONS CAREFULLY BEFORE ASSEMBLING				
Laser according to the standard EN 60825-1: 2015-12				

Ed. 12/2025 - All specifications are subject to change without notice