

LASER POINTER LSVR12 SERIES - RED LIGHT - Ø12 - 1mW

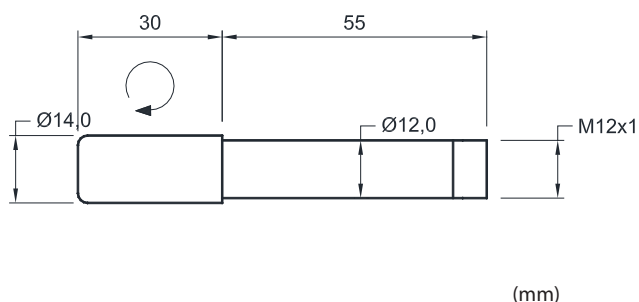

Laser pointer consisting of a high quality red light laser diode, available in the wavelength of 635 nm and with a power of 1mW.

The focus adjustment allows you to obtain a well-focused line up to a maximum height of 0.5 m from the work surface.



Connection M12x1 connector



1 = Brown = Positive + Vcc.
2 = Free
3 = Blue = Negative GND
4 = Free

Accessories page 52

Type	LSVR12-650-1-T10-P-Y		LSVR12-635-1-T20-X15°-Y	LSVR12-635-1-T20-60-Y
Art. no.	SM319030		SM323008	SM324002
Mounted lens	point		cross with 15° lens Plastics Diffractive Lens	line
Point diameter at 1 m distance	~ Ø 1,0 mm		-	-
Cross dimension at 1 m distance	-		250 x 250 mm	-
Line length at 1 m distance	-		-	600 mm
Power supply	5...24 Vdc			
Power	1 mW			
Wavelength	650nm		635nm	
Beam divergence	0,5 mrad		-	-
Minimum line thickness	-		-	~ 1,5 mm
Life time at 20°C	≥ 20.000 h			
Permitted temperature	-10°...+50°C			
Focus adjustment	yes			
Tolerance of the lens for line	± 15%			
Current consumption	~ 10 mA typical			
Automatic control of the output power	yes			
Reverse polarity and overvoltage protections	yes			
Housing material	aluminum			
Cable connection	connector M12x1			
Degree of protection	IP40		IP67 ring / IP54 housing	
Classe di sicurezza	<div><div></div><div>LASER 2</div><div></div></div>			
For the classification of the laser systems: only in perfect conditions and supplied with DC power supply, the system can be specified in the safety class, according to the new regulations in force since 12/15.				
Laser according to the standard EN 60825-1: 2015-12				

Ed. 12/2025 - All specifications are subject to change without notice