

## LASER POINTERS LSH14 SERIES - RED LIGHT - Ø14 - 5mW

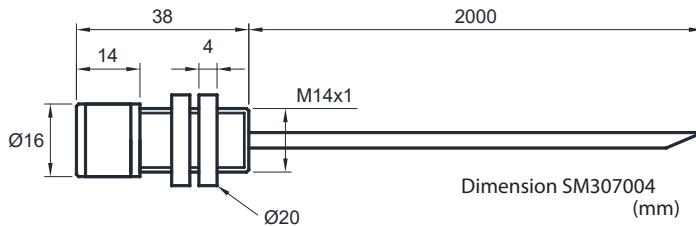

Laser pointer consisting of a high-quality laser diode, guaranteed for a lifespan of > 20,000 hours, available in wavelength = 635 nm and with a power of 5mW.



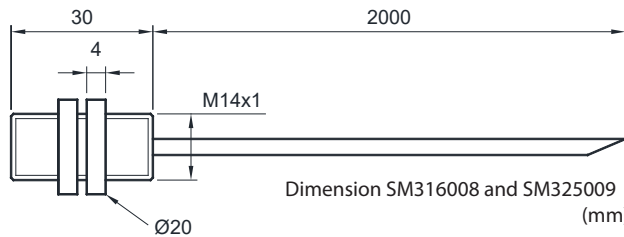

Dimension SM307004 (mm)

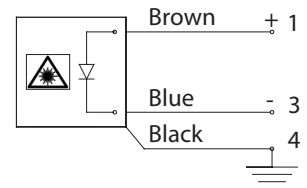

Dimension SM316008 and SM325009 (mm)



### Accessories page 52

Modello	LSH14-635-5-T20-P	LSH14-635-5-T20-X15°	LSH14-635-5-T20-60-2MT
Art. n.	SM316008	SM325009	SM307004
Tipo di lente	point	cross	line
Point diamter at 1m	~ Ø 2.5 mm	-	-
Line length at 1 m	-	-	1.2m +/- 15%
Cross dimension at 1 m	-	250x250 mm	-
Power supply	2,5-5,0Vdc		
Power	5 mW		
Wavelength	635 nm		
Beam divergence	0.5 mrad	-	-
Life time at 20°C	≥ 20.000 h		
Permitted temperature	-10°...+50°C		
Focus adjustment	yes, by screwdriver		
Current consumption	< 50 mA		
Reverse polarity and over-voltage protections	no		
Housing material	alluminum		
Cable connection	cable 2m		
Degree of protection	IP40		
Safety protection class			

(\*) If you remove the ring from the pointer wiht cross lens, the safety class changes to 3R

For the classification of the laser systems: only in perfect conditions and supplied with DC power supply, the system can be specified in the safety class, according to the new regulations in force since 12/15.

READ THE INSTRUCTIONS CAREFULLY BEFORE ASSEMBLING

Laser according to the standard EN 60825-1: 2015-12